



ELECTRICAL WIRING ACCESSORIES.

GoldStar International



WEB : WWW.GOLDSTAR-INTERNATIONAL.COM

Experience the
Glitter of Brass...
Varied Multi-Purpose
Brass Products.



perfections : 079 - 6631 4519. Cell : 098257 23722.

An ISO 9001 : 2000 Certified Company

COMPANY PROFILE

GOLDSTAR GROUP OF COMPANY is a Manufacturers and Exporters of BRASS ELECTRICAL WIRING ACCESSORIES. Company has a manufacturing plant with the Strength of Skilled Laborers, Qualified Engineers Situated in Jamnagar (India). A well known Brass City in the World.

Our Company has emerged as a pioneer in the electrical arena. The Pool of proficient employees and the help of advanced technology has served the company to become a major player in its business segment.

We are approved by the major international Certification agencies. It has helped us to be recognized globally as a market leader.

The strong R & D has maintained the quality and standard according to the market needs.

Our professionally managed company is fully involved in the manufacturing & exporting of Quality and wide range of Brass Electrical Wiring Accessories including Auto Electrical Parts and many other Products..

Our Range of Products is:-

- Brass / Copper & G.I. Electrical Wiring Accessories.
- Brass Auto Electrical Parts & Accessories.
- Brass Sanitary Parts.
- Brass Building Hardware's.
- Brass & M.S. Fasteners.
- Any other Brass/Copper Components as per customers drawing and Samples.

All our products are reliable, Cost effective & durable in nature. They are in accordance with the required international quality Standards.

We have been meeting the requirements of the major industries and to our spectrum of precision components have diverse industrial applications. The wide range of superior quality products are widely used in the following industries:-

- Telecommunication
- Auto Industries
- Cable Manufacturing Industries
- Power & Electricity
- Shipping & Dock Manufacturing Industries
- Rapid transit systems
- Chemical Industries & refineries etc.

We have been appreciated worldwide for our never-ending pursuit of producing qualitative products. The sound infrastructure, professional management, required workforce has made us capable of undertaking & completing orders of all stature, within the time bound. We have been catering to the vast demand of International market products Range.

Almost 37 years of industry experience and expertise in our domain have enabled us to manufacture superior quality products. Quality is a never ending process. Our high degree of quality is maintained through a through scrutiny of raw materials, regular machinery maintenance and in-process inspection. These have been embedded into our production schedule and we are strictly adhered to. There is a strong emphasis on continuous improvement and on avoiding time delays.

We manufacture a special range of machines brass components as per client specifications in various sizes. We design and manufacture distinct brass turning parts also that are widely used in industrial applications.

Our Motto

To **Serve You** the
Quality Products
within **Reasonable Price.**





BW BRASS CABLE GLAND



BW GLAND FOR SWA CABLE

- To BS 6121 Part 1.
- Suitable for single wire armoured, plastic or rubber sheathed cables.
- Application-for use in dry, indoor situations.
- Low cost two part design.
- Shroud may be used for additional ingress protection IP 54.
- Finish : Natural Brass and also available in Electro, Tinned and Nickel.
- Threads : Entry threads are metric to BS 3643 and are also available in Imperial (ET).
- Also available in Aluminum (BS 1474) cable glands.
- Available in Kit Packing.
- Kit Packing includes GLANDS, EARTH TAG, PVC SHROUD.

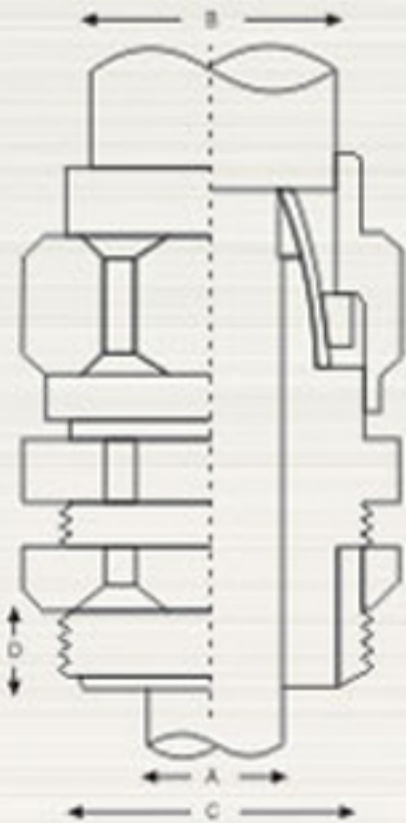

APPLICATION

For use with all type of SWR cable where no seal is required on to cables inner or outer sheathing.

GLAND REF & SIZE	TERMINATION THREAD SIZE "C"		MINIMUM LENGTH OF THREAD "D"	CABLE DIAMETER	
	METRIC	IMP		DIA INNER SHEATH MAX.'A'	DIA OUTER SHEATH MAX.'B'
BW	20S	3/4	10	12.0	18.0
BW	20L	3/4	10	15.0	20.8
BW	25S	1	10	17.0	23.0
BW	25L	1	10	20.0	28.0
BW	32L	1 1/4	10	26.0	34.0
BW	40S	1 1/2	15	29.0	37.0
BW	40L	1 1/2	15	32.5	41.5
BW	50S	2	15	38.0	46.5
BW	50L	2	15	40.0	51.0
BW	63S	2 1/2	15	45.0	57.0
BW	63L	2 1/2	15	48.0	59.0
BW	75S	3	15	54.0	66.0
BW	75L	3	15	62.0	72.0
BW	90S	3 1/2	15	67.0	80.0
BW	90L	3 1/2	25	73.0	86.0
BW	100	4	25	89.0	100.0



CW BRASS CABLE GLAND

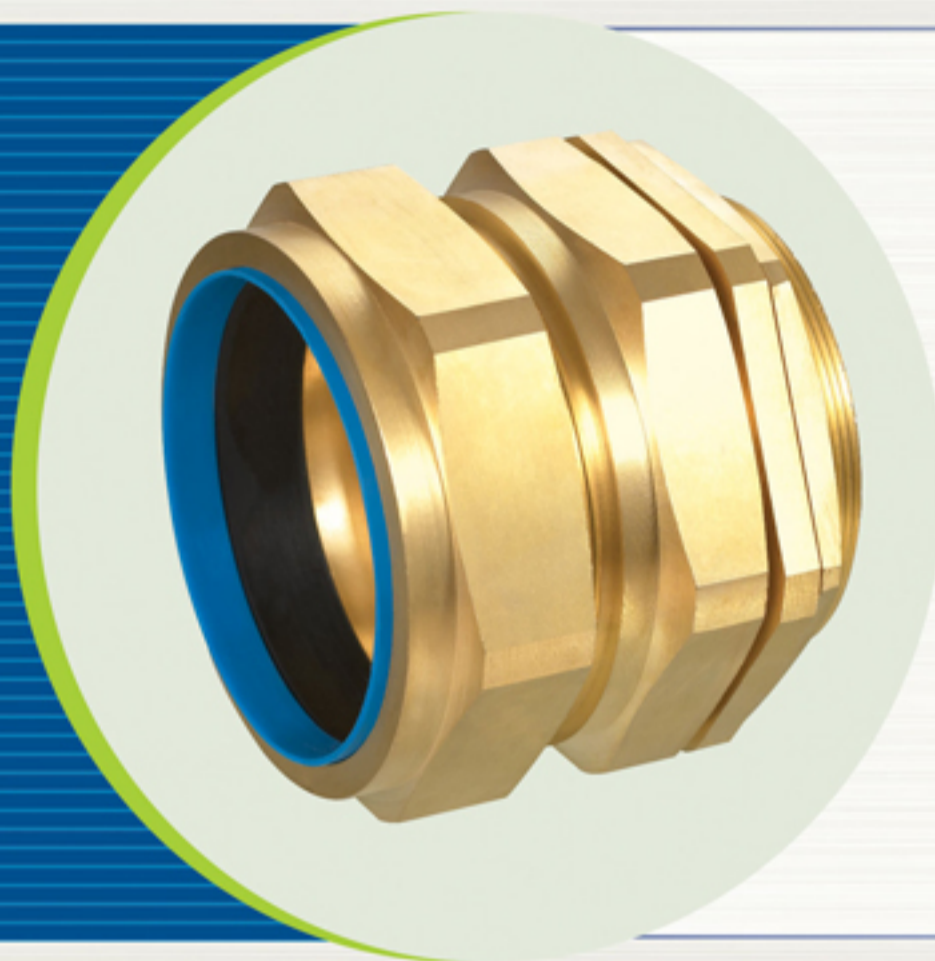

CW GLAND FOR SWA CABLE

- To BS 6121 : Pt 1.
- Suitable for single wire armoured, plastic or rubber sheathed cables.
- Outer seal grips sheath of cable.
- For use in most climatic conditions weatherproof and waterproof.
- Seal rated to IP 66.
- Design has separate armour locking ring.
- Gland rated to IP 66 with use of suitable sealing washer or thread sealant at gland interface.
- Finish : Natural Brass and also available in Electro Tinned and Nickel.

CW FLAME PROOF GLAND FOR SWA CABLE

- As above but with these additional benefits.
- For use in hazardous environments.
- Complies with BS 5501 Pt 1 & Pt 6.
- CW for flame proof increased safety application.
- Threads : Entry threads are material to BS 3643 and are also available in Aluminum.
- Also available in Aluminum (BS 1474) cable glands.
- Available in Kit Packing.
- Kit Packing includes GLANDS, EARTH TAG, PVC SHROUD.

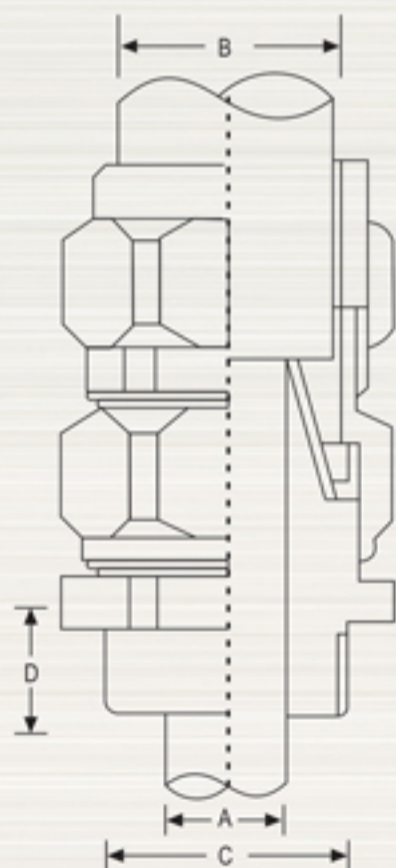
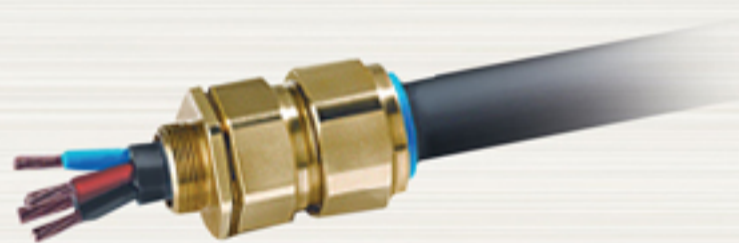

APPLICATION

For use with all types SWA cable and where it is essential to produce an IP 66 seal onto the outer sheath.

GLAND REF & SIZE	TERMINATION THREAD SIZE "C"		MINIMUM LENGTH OF THREAD "D"	CABLE DIAMETER	
	METRIC	IMP		DIA INNER SHEATH MAX. "A"	DIA OUTER SHEATH MAX. "B"
CW	20S	3/4	10	12.0	18.0
CW	20L	3/4	10	15.0	20.8
CW	25S	1	10	17.0	23.0
CW	25L	1	10	20.0	28.0
CW	32L	1 1/4	10	26.0	34.0
CW	40S	1 1/2	15	29.0	37.0
CW	40L	1 1/2	15	32.5	41.5
CW	50S	2	15	38.0	46.5
CW	50L	2	15	40.0	51.0
CW	63S	2 1/2	15	45.0	57.0
CW	63L	2 1/2	15	48.0	59.0
CW	75S	3	15	54.0	66.0
CW	75L	3	15	62.0	72.0
CW	90S	3 1/2	20	67.0	80.0
CW	90L	3 1/2	20	73.0	86.0
CW	100S	4	25	90.0	102.0
CW	100L	4	25	93.0	115.0

A1 / A2 BRASS CABLE GLAND



A1/A2 GLAND FOR UNARMoured CABLE

- To BS 6121 : Part 1.
- Suitable for unarmoured, plastic or rubber sheathed cables.
- Suitable for most indoor and outdoor applications.
- Seal rated to IP 66.
- Finish : Natural Brass and also available in ,
- Electro Tinned and Nickel.

A2 FLAME PROOF FOR UNARMoured CABLE

As above but with these additional benefits.

- For use in hazardous environments.
- Complies with BS 5501 Pt 1 & Pt 6.
- A2 F for flame proof increased safety applications.
- Threads : Entry threads are metric to BS 3643 and are also available in Imperial (ET).
- Also available in Aluminum (BS 1474) cable glands.

Assembly of Gland Body

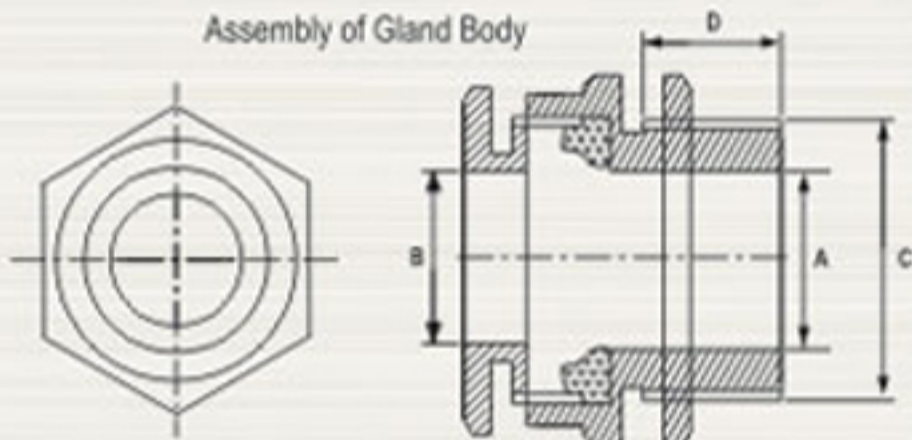

APPLICATION

For use with all types of unarmoured and PVC cable where it is essential to produce IP 66 or explosion proof seal on inner sheath.

GLAND REF & SIZE	TERMINATION THREAD SIZE "C"		MINIMUM LENGTH OF THREAD "D"	CABLE DIAMETER	
	METRIC	IMP		MAX. "A"	MAX. "B"
A2	20S	3/4	10	11.7	8.0
A2	20L	3/4	10	14.0	11.0
A2	25S	1	10	17.0	12.0
A2	25L	1	10	20.0	13.0
A2	32S	1 1/4	10	23.0	16.5
A2	32L	1 1/4	10	26.3	19.0
A2	40S	1 1/2	15	29.0	23.0
A2	40L	1 1/2	15	33.0	25.0
A2	50S	2	15	38.2	31.5
A2	50L	2	15	46.0	36.5
A2	63S	2 1/2	15	50.1	42.5
A2	63L	2 1/2	15	56.0	44.5
A2	75S	3	15	62.0	54.5
A2	75L	3	15	68.0	60.5
A2	90S	3 1/2	15	77.0	66.0
A2	100	4	25	88.0	80.0
A2	110	4 1/2	25	95.0	89.0



E 1 W BRASS CABLE GLAND



E 1 W GLAND FOR SWA CABLE

- Suitable for single wire armoured, plastic or rubber sheathed, extruded bedded cable.
- Outer seal grips sheath of cable.
- inner seal grips bedding layer of cable.
- For use in most climatic conditions weatherproof and waterproof.
- Inner and outer seal rated to IP 66.
- Design has separate armour locking ring.
- Gland rated to IP 66 with use of suitable sealing washer or thread sealant at gland interface.
- Finish : Natural Brass and also available in Electro Tinned and Nickel.

E1W FLAME PROOF GLAND FOR SWA CABLE

- For use in hazardous environments.
 - Complies with BS 5501 Pt 1 & Pt 6.
 - E1W Increased safety application.
 - Threads : Entry threads are metric to BS 3643 and are also available in Imperial (ET).
 - Also available in Aluminum (BS 1474) cable glands.
- Available in Kit Packing.
Kit Packing includes GLANDS, EARTH TAG, PVC SHROUD.

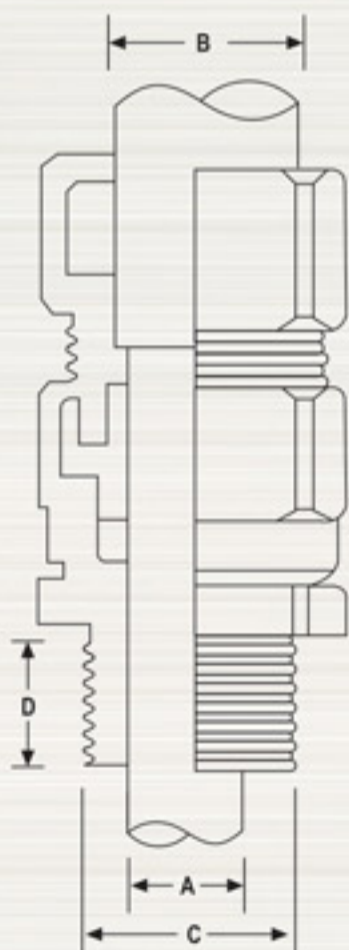

APPLICATION

For use with types unarmoured cables where it is essential to provide an IP 66 or explosion proof seal on the outer sheath

GLAND REF & SIZE	TERMINATION THREAD SIZE "C"		MINIMUM LENGTH OF THREAD "D"	CABLE DIAMETER	
	METRIC	IMP		DIA INNER SHEATH MAX."A"	DIA OUTER SHEATH MAX."B"
E1W	20S	3/4	10	12.0	18.0
E1W	20L	3/4	10	15.0	20.8
E1W	25S	1	10	17.0	23.0
E1W	25L	1	10	20.0	28.0
E1W	32L	1 1/4	10	26.0	34.0
E1W	40S	1 1/2	15	29.0	37.0
E1W	40L	1 1/2	15	32.5	41.5
E1W	50S	2	15	38.0	46.5
E1W	50L	2	15	40.0	51.0
E1W	63S	2 1/2	15	45.0	57.0
E1W	63L	2 1/2	15	48.0	59.0
E1W	75S	3	15	54.0	66.0
E1W	75L	3	15	62.0	72.0
E1W	90S	3 1/2	15	67.0	80.0
E1W	90L	3 1/2	15	73.0	86.0
E1W	100S	4	25	90.0	102.0
E1W	100L	4	25	93.0	115.0



'G' TYPE GLAND FOR SWA CABLE

- For use with SWA, Plastic & Rubber sheathed cable Used in dry indoor conditions.
- Innerring ensures positive armour clamp and earth continuity.
- Finish : Natural Brass and also available in Electro Tinned and Nickel.
- Threads : Entry threads are metric to BS 3643 and are also available in Imperial (ET).
- Also available in Aluminum (BS 1474) cable glands.

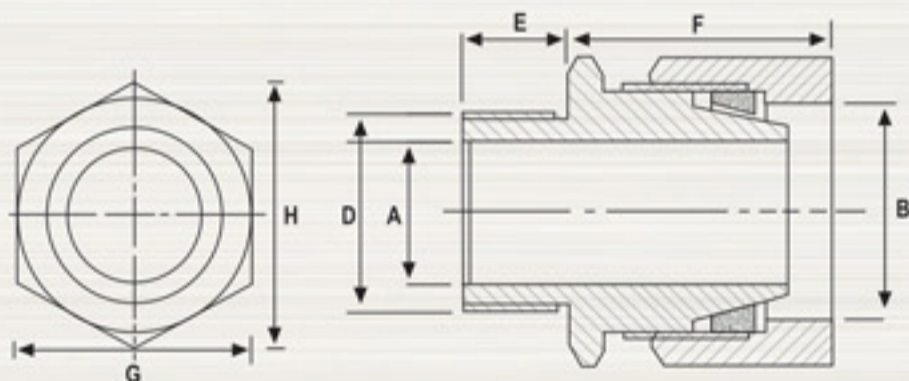

APPLICATION For use with all type of SWR cable where no seal is required on to cables inner or outer sheathing.

GLAND REF	SIZE	CABLE DIMENSIONS ACCOMODATED				GLAND DIMENSIONS				
		DIAMETER		OVERALL B MAX mm.	ARMOUR WIRE DIAMETER C mm.	ISO ENTRY THREAD		APPROX. LENGTH FROM SHOULDER F mm.	HEXAGON SIZE.	
		UNDER ARMOUR A MIN mm.	MAX mm.			DIA D mm.	LENGTH E mm.		ACROSS FLATS G mm.	ACROSS CORNERS H mm.
ALCO	G-204	-	15.8	15.8	0.9/1.25	20	10	24	22.0	24.9
ALCO	G-206	-	21.0	21.0	0.9/1.25	20	10	25	27.0	30.0
ALCO	G-254	-	23.8	23.8	1.25/1.60	25	10	26	31.7	35.7
ALCO	G-256	-	27.2	27.2	1.25/1.60	25	10	26	37.6	42.2
ALCO	G-324	-	33.2	33.2	1.60/2.0	32	10	28	47.3	53.6
ALCO	G-326	-	39.9	39.9	1.60/2.0	40	15	25	48.4	54.6
ALCO	G-405	-	39.9	39.9	1.60/2.0	40	15	25	50.0	57.0
ALCO	G-503	-	51.6	51.6	2.0/2.25	50	15	36	58.0	64.2
ALCO	G-505	-	52.6	52.6	2.0/2.25	50	15	36	65.0	71.2
ALCO	G-636	-	61.0	61.0	2.5	63	15	30	71.0	77.5
ALCO	G-753	-	71.3	71.3	2.5	75	15	40	85.0	95.0
ALCO	G-755	-	78.0	78.0	2.5	75	15	40	98.0	109.2



MARINE CABLE GLANDS



Size : 10 mm. to 70 mm.

Application : Free Cutting Brass as per BS 249 Type
Used for Various Applications.

Finish : Natural Chrome Plated, Tin Plated, Cutting as per
Customer Specification.

KIT PACKING IN GOLDSTAR BRAND



TINNED COPPER CABLE TERMINAL ENDS (LUGS)



BRASS AUTO TERMINALS

- ANGLE TYPE TERMINAL.
- STRIP TYPE TERMINAL.
- LUCAS TERMINAL (SCREW/BOLT TYPE).
- PIN TYPE TERMINAL.
- FORGED TERMINAL.

BRASS & M.S. FASTNERS



BRASS WOOD / MIRROR SCREW



M.S. FASTNERS



EARTHING EQUIPMENTS & FITTINGS



ADAPTOR.

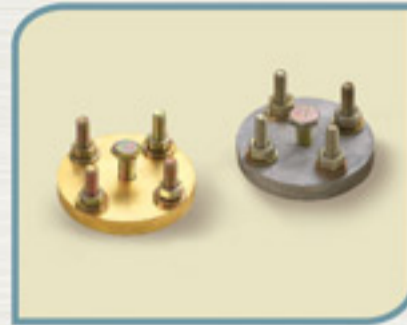

TEST BOND.
BRASS / ALUMINUM.

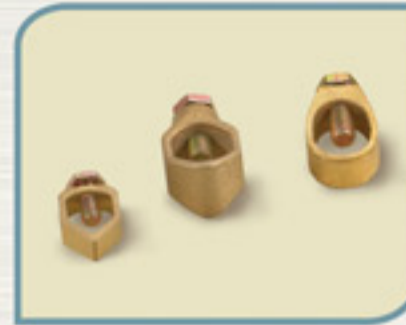

'A' CLAMP.



COUPLER COUPLING.

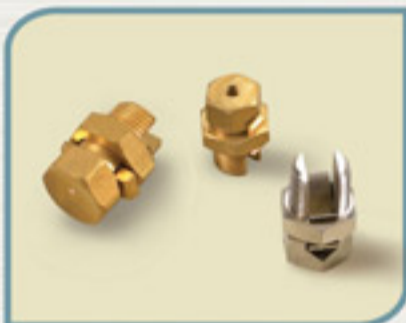

LINE TAP.



CROSS SADDLE.



SADDLE BAR.



'B' CLAMP.



LIGHTNING ARRESTOR.

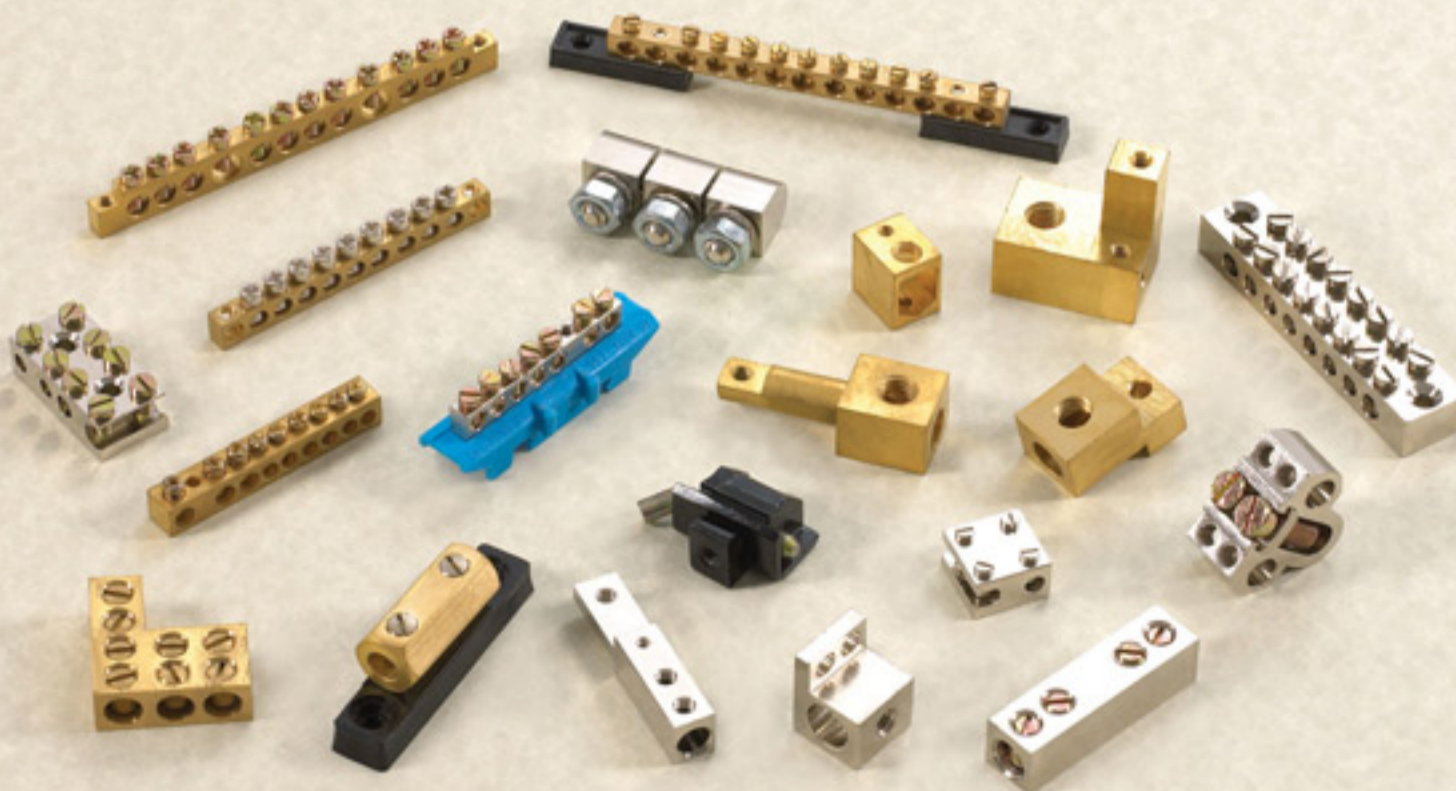

- BRASS NEUTRAL LINK / EARTH BAR / TERMINAL.
- FUSE BASE BAR.
- TERMINAL BLOCK.



EARTHING EQUIPMENTS & FITTINGS



CROSS SADDLE / SQUARE TYP CLAMP
 SIZE (mm)
 : 25 x 3, 25 x 4, 25 x 6, 50 x 6.



OBLONG TEST CLAMP / JUNCTION CLAMP
 SIZE (mm) :
 25 x 3, 50 x 6.



TOWER EARTH CLAMP
 SIZE (mm) :
 16 x70, 70 x 120.



DC TAP CLIP
 SIZE (mm) : 25 x 3, 25 x 6, 38 x 3, 38 x 6, 50 x 3.



CLAMP - G
 SIZE (mm) : 9.5, 11, 12.7, 16, 17, 20, 20.
 ROD DIAMETER : 6-35, 6-35, 16-70, 16-70, 16-95,
 35-120, 35-120, 70-185.



CLAMP - A
 SIZE (mm) :
 9.5, 11, 12.7, 14.2, 16, 17.2, 20.
 ROD DIAMETER :
 25, 25, 25, 25, 40, 50, 50.



TEST CLAMP
 SIZE (mm) :
 50 x 6, 50, 70.



ROD TO CABLE LUG CLAMP TYPE 'B'
 SIZE (mm) : 9.5, 11, 12.7, 14.2,
 15, 16, 17.2, 20, 25.





G.I. CONDUIT FITTINGS

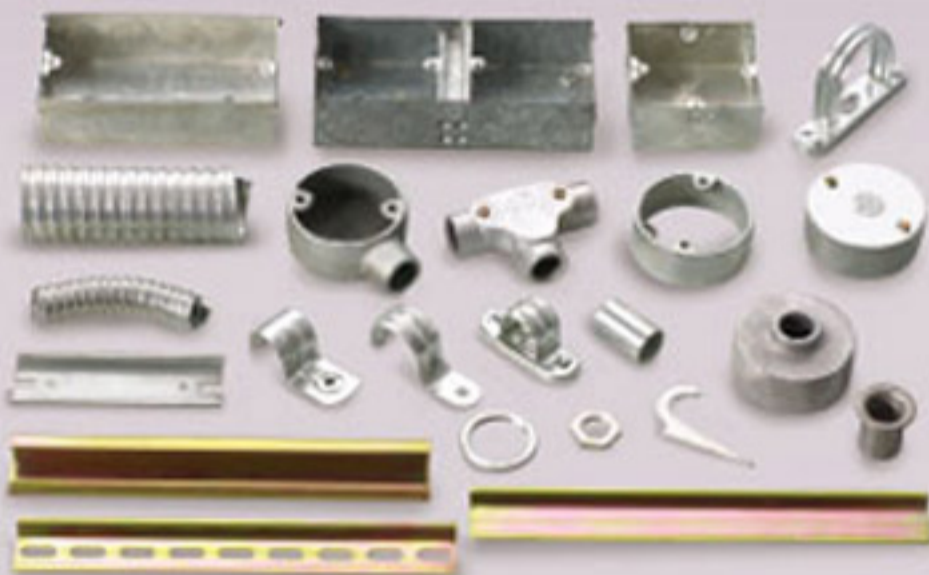

- **JUNCTION BOX.**
Available in 3/4" (20mm), 1" (25mm), 1 1/4" (32mm), 1 1/2" (38mm), 2" (50mm), in Galvanised & Hot Dip Galvanised.
- **ELBOW, TEE & BEND.**
Available from 3/4" (20mm) to 2" (50mm).
- **GALVANISED FLEXIBLE PIPES.**
Available in 1/2", 5/8", 3/4", 7/8", 1", 1 1/4", 1 1/2", 2".
- **DOOR & HOOK COVER.**
Available in 3/4" (20mm) & 1" (25mm).
- **DIN RAIL.**



- **G.I. BAR SADDLE.**
Available From size 3/4" (20mm) to 2" (50mm).
In light and Heavy Duty.
- **G.I. HALF SADDLE.**
Available From size 3/4" (20mm) to 2" (50mm).
- **G.I. SOCKET (COUPLING).**
Available From size 3/4" (20mm) to 2" (50mm).
- **G.I. LOCK / RING NUT.**
Available From size 3/4" (20mm) to 2" (75mm).
- **REDUCER.**
Available in various Sizes.
- **ALUMINUM ADAPTOR.**
Available From size 3/4" (20mm) to 2" (50mm).



BRASS FANCY BUILDERS HARDWARES



- BRASS TOWER BOLTS.

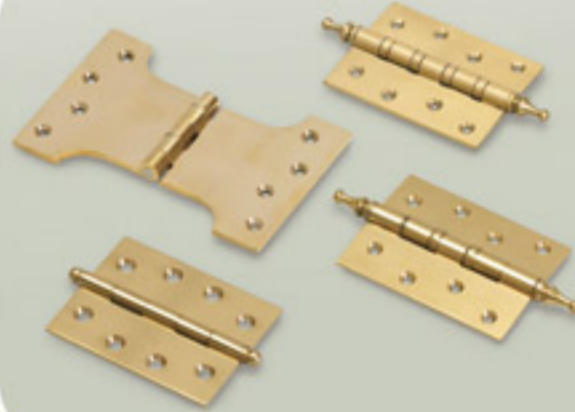

- BRASS HINGES.**
- MORTISE HINGES.
 - PARLIAMENT HINGES.
 - BUTT HINGES.
 - BEARING HINGES.
 - RAILWAY TYPE HINGES.



- BRASS CABIN HOOK.
- BRASS CASMENT STAY (WINDOW ADJUSTER).



- BRASS DOOR HANDLE.



- BRASS ALDROP.
- BRASS NUMBERS.



- BRASS DOUBLE BALL.
- CATCHES.
- BRASS BRACKET (GLASS BRACKET).
- BRASS HASP & STAPLE.
- BRASS DOOR STOPPER.

Available Finish with Polished Brass, Lacquered Finish, Satin Lacquered Finish, Satin Nickle Finish, Antique Bronze Finish, Gold Plated Finish, Black o Plated Finish, OR As per Customers Requirements / Specification.

OUR RANGE OF PRODUCTS



BRASS CABLE GLAND

- Wiping Gland.
- CW Gland.
- BW Gland (4 Part / 2 Part).
- A1 - A2 Gland.
- FLANGE TYPE.
- G - Gland.
- Marine Gland.
- E1W Gland.
- PG Gland.
- Double Compression Gland.
- Earth Tag Regular / Oval.



BRASS MOLDING PARTS

- Brass Inserts.
- Brass Molding Inserts.
- Brass Threaded Inserts.
- Brass Straight Knurled Molding Inserts.



BRASS TURNING PARTS.



BRASS SANITARY BATHROOM FITTINGS.



An ISO 9001 : 2000 Certified Company
Quality Management Standard

We are Proud to be Member of :-
Export Promotion Council for EOU's and SEZ (EPCES)

MANUFACTURER & EXPORTER OF :

- BRASS, COPPER & G.I. ELECTRICAL WIRING ACCESSORIES.
- BRASS BUILDERS HARDWARE FITTINGS.
- BRASS COMPONENTS.
- BRASS SANITARY FITTINGS.
- BRASS AUTO PARTS.
- BRASS / COPPER ALLOY EXTRUSION RODS, BARS, SECTION & PROFILES.



(A Govt. of India Recog. 100% Export Oriented Unit)

Sp. Shed No. 405/B, G.I.D.C. Industrial Estate,
Shanker Tekri, Jamnagar - 361 004 (INDIA).
Phone : 91 - 288 - 2567708, 2560403.
Fax : 91 - 288 - 2560515.

E-mail : gold_intl@sancharnet.in
goldstar_intl@dataone.in

Web : www.goldstar-international.com

**Efficient, Efflorescence
In Electrical Arena**

www.goldstar-international.com